

# COSMETICS RANGE DISPENSERS

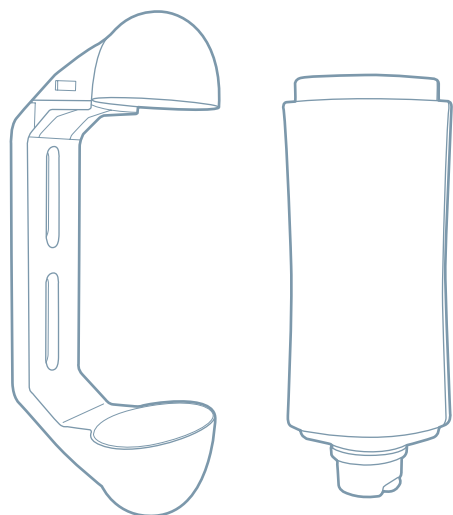

how to use / modo d'uso / comment l'utiliser /  
Gebrauchsanweisung / modo de uso

DSR330-T



wall bracket  
DS5 or DS6

dispenser  
recharge

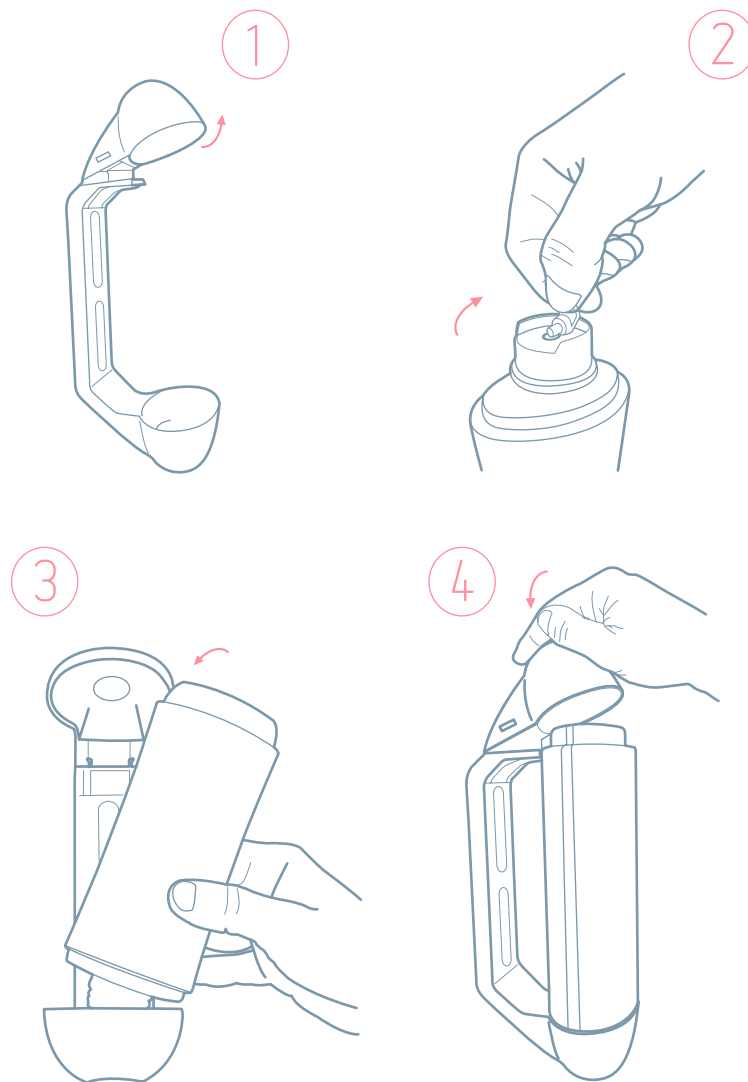

With  
security  
key!

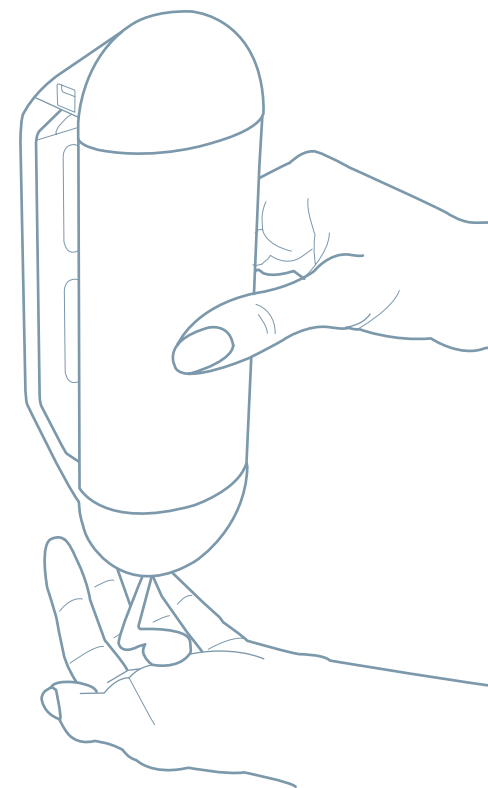

Made in Italy

DSR330\_T ≥2.500 pcs

Dispenser recharge "Squeezable", 330 ml / Ricarica dispenser "Squeezable", 330 ml / Recharge dispenser "Squeezable", 330 ml / Spenderflasche "Squeezable" 330 ml / Recarga dispensador "Squeezable", 330 ml

BASE / BASIS

4,8 x 6,5 cm

LABEL OPTIONS  
VARIANTI ETICHETTA  
OPTIONS DE L'ÉTIQUETTE  
OPTIONEN FUER DAS ETIKETT  
OPCIONES DE ETIQUETA

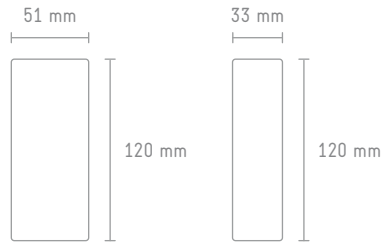
●ETDSR330\_A  
front●ETDSR330\_B  
front●ETDSR330\_RA  
back●ETDSR330\_RB  
back

 COSMETICS  
COSMETICI  
COSMÉTIQUES  
KOSMETIK  
COSMÉTICOS  
pag II

 PERSONALIZATION  
PERSONALIZZAZIONI  
PERSONALISATIONS  
PERSÖNLICHE GESTALTUNG  
PERSONALIZACIONES  
pag 218

\* Available only front or front and back label  
Disponibile etichetta solo fronte o fronte e retro  
Disponible étiquette seulement recto ou recto et verso  
Erhältlich nur: Vorderseite oder Vorder- und rüeckseite etikett  
Disponibile etiqueta sólo frontal o frontal y trasera



MATERIALS  
MATERIALI  
MATÉRIAUX  
MATERIALIEN  
MATERIALES



●DSR330\_BI

●DSR330\_TR

## DSS

Wall bracket with stainless steel expansion screws / Staffa con chiave apertura e viti in acciaio inox ad espansione / Support avec clé d'ouverture et vis en acier inox à extension / Spenderhalterung mit Schlüssel und Befestigungsschrauben aus Edelstahl / Soporte con llave de seguridad y tornillos de extensión de acero inoxidable

## DSB

Wall bracket with two-sided adhesive tape / Staffa con supporto per incollatura a parete con biadesivo / Support pour encollage au mur avec ruban adhésif double face / Spenderhalterung mit doppelseitigem Klebeband zur Wandbefestigung / Soporte biadhesivo para fijar en la pared



● DSS#BI ● DSS#TR  
● DSB#BI ● DSB#TR



● DSS#AT ● DSS#VT



● DSS#AL ● DSS#AO ● DSS#OL

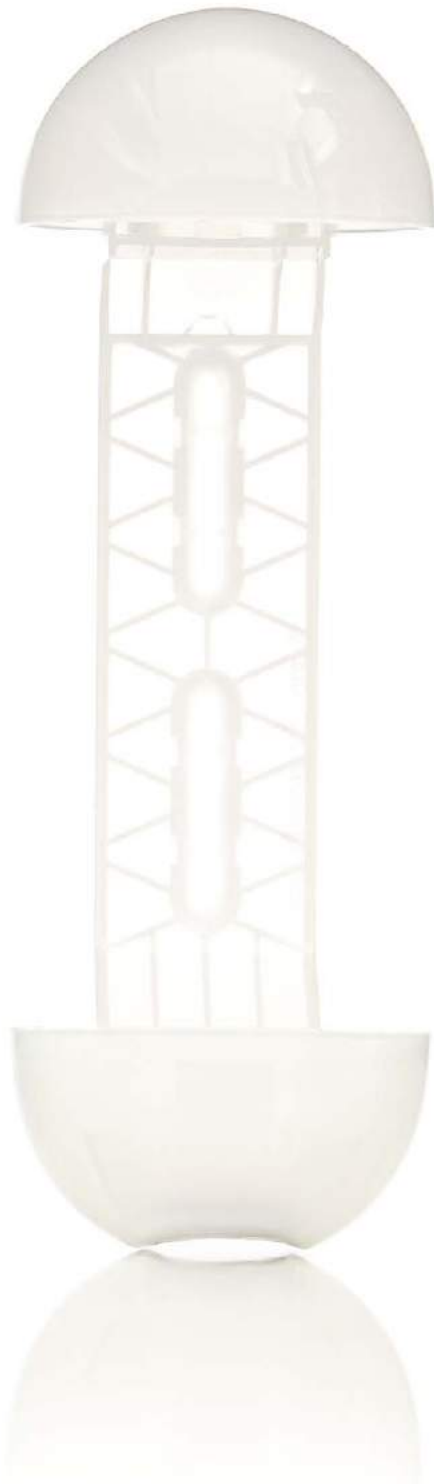

how to use / modo d'uso / comment l'utiliser /  
Gebrauchsanweisung / modo de uso

*AMR341-T*

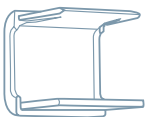

*wall bracket  
HMS  
valve  
HMC*

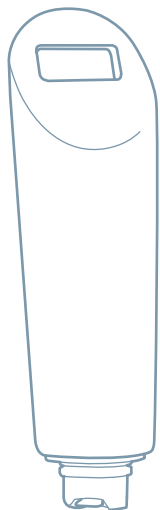

*dispenser  
recharge*

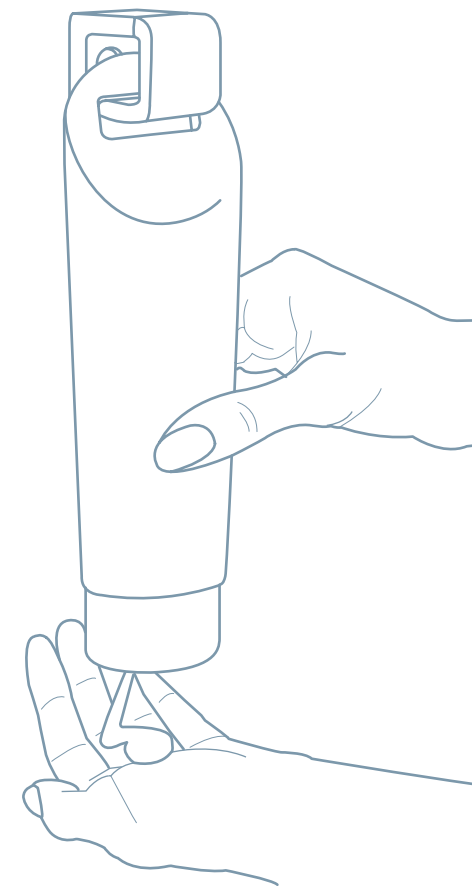
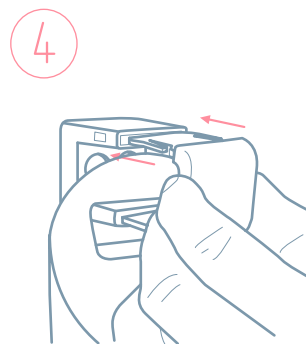
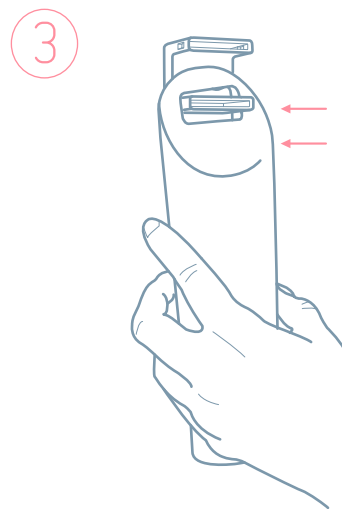
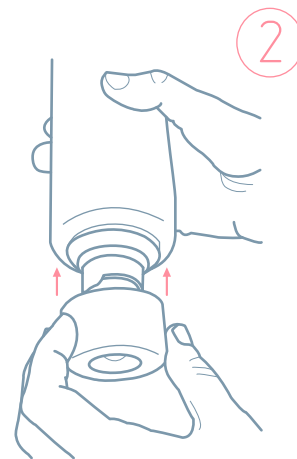
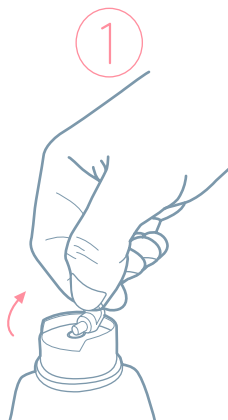

*Made in Italy*

# HMR341\_T ≥2,500 pcs

Dispenser recharge "Swing me" with front and back label, 340 ml / Ricarica dispenser "Swing me" con etichetta fronte e retro, 340 ml / Recharge dispenser "Swing me" avec étiquette recto et verso, 340 ml / Spenderflasche "Swing me" mit Etikett auf Vorder- und Ruckseite, 340 ml / Recarga dispensador "Swing me" con etiqueta frontal y trasera, 340 ml

BASE / BASIS

∅ 5 cm

LABEL  
ETICHETTA  
ÉTIQUETTE  
ETIKETT  
ETIQUETA

49 mm

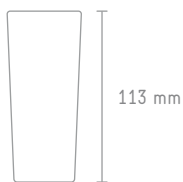

113 mm

●ETHMR341\_A + ●ETHMR341\_RA  
front + back



COSMETICS  
COSMETICI  
COSMÉTIQUES  
KOSMETIK  
COSMÉTICOS

pag II



PERSONALIZATION  
PERSONALIZZAZIONI  
PERSONNALISATIONS  
PERSÖNLICHE GESTALTUNG  
PERSONALIZACIONES

pag 218

\* Available only front and back label  
Disponibile solo etichetta fronte e retro  
Disponble seulement étiquette recto et verso  
Erhaeltlich nur: Vorder und ruckseite etikett  
Disponible sólo etiqueta frontal y trasera



MATERIALS  
MATERIALI  
MATÉRIAUX  
MATERIALIEN  
MATERIALES



●HMRV341\_BI



●HMRV341\_TR



●HMRV341R\_GR

## HMS

Wall bracket with stainless steel expansion screws + one valve / Staffa con chiave apertura e viti in acciaio inox ad espansione + coprivalvola / Support avec clé d'ouverture et vis en acier inox à extension + un bouchon / Spenderhalterung mit Schlüssel und Befestigungsschrauben aus Edelstahl + Abschlusskappe / Soporte con llave de seguridad y tornillos de extensión de acero inoxidable + un tapón



## HMB

Wall bracket with two-sided adhesive tape + one valve / Staffa con supporto per incollatura a parete con biadesivo + coprivalvola / Support pour encollage au mur avec ruban adhésif double face + un bouchon / Spenderhalterung mit doppelseitigem Klebeband + Abschlusskappe / Soporte biadhesivo para fijación en la pared



## HMC

Valve / Coprivalvola / Bouchon / Abschlusskappe / Tapón



- HMS#BI ● HMS#ZW6 ● HMS#P7545
- HMB#BI ● HMB#ZW6 ● HMB#P7545
- HMC#BI ● HMC#ZW6 ● HMC#P7545



how to use / modo d'uso / comment l'utiliser /  
Gebrauchsanweisung / modo de uso

*FLR400-T*

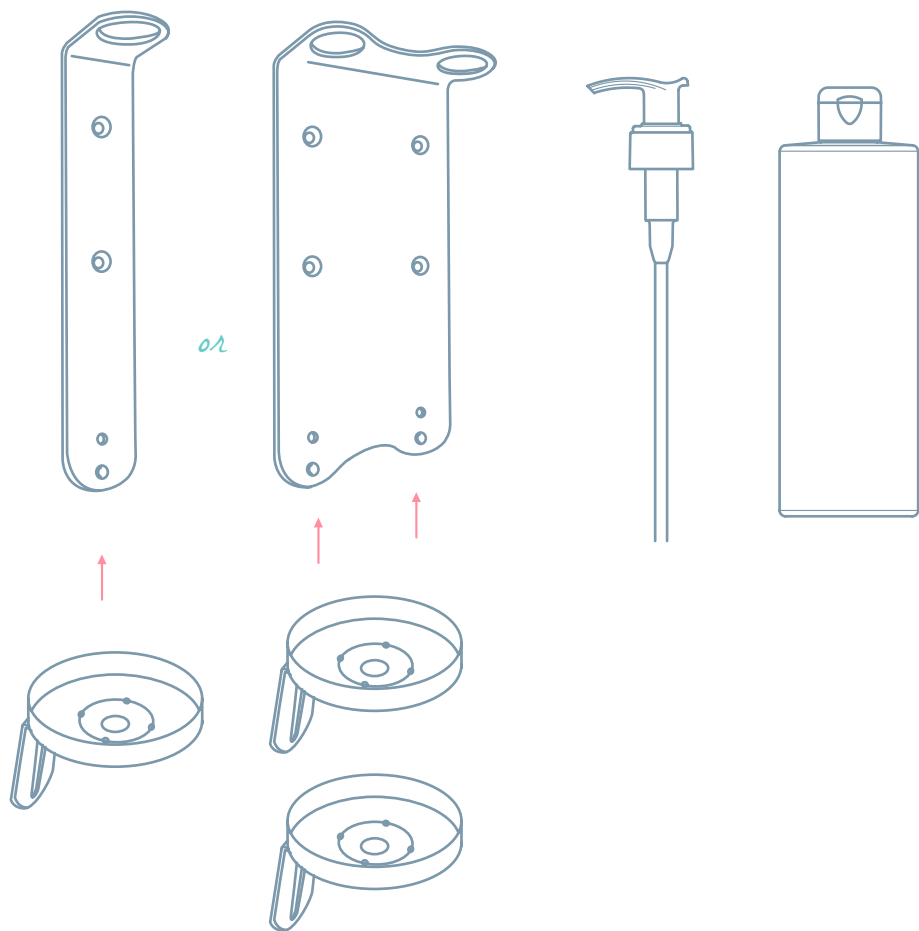

*Wall Bracket in  
aluminium*

①

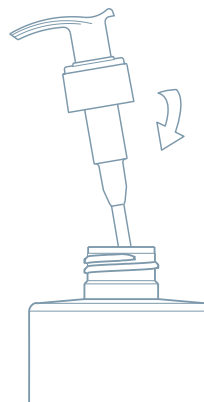

②

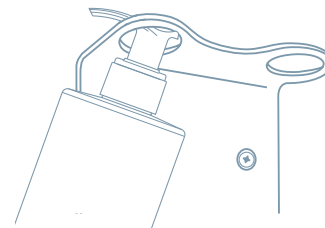

③

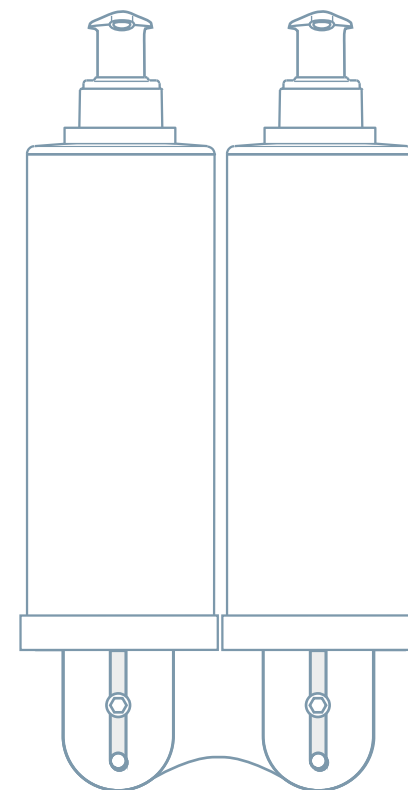
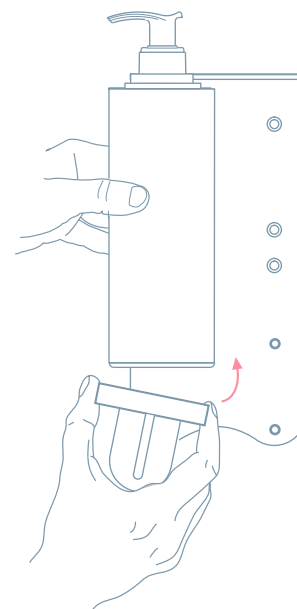



FLR400\_T ≥2,500 pcs

Cylindrical dispenser in PET,  
380 ml / Dispenser cilindrico in  
PET, 380 ml / Dispenser cylin-  
drique en PET, 380 ml / Spender  
Zylindrischer Flakon aus PET,  
380 ml / Botella cilíndrica en  
PET, 380 ml

BASE / BASIS

 ∅ 5,9 cm

LABEL OPTIONS  
VARIANTI ETICHETTA  
OPTIONS DE L'ÉTIQUETTE  
OPTIONEN FUER DAS ETIKETT  
OPCIONES DE ETIQUETA

45 mm

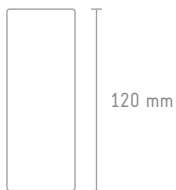

● ETFLR400\_A  
front

48 mm

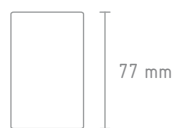

● ETFLR400\_C  
front

● ETFLR400\_RA  
back

● ETFLR400\_RC  
back



COSMETICS  
COSMETICI  
COSMÉTIQUES  
KOSMETIK  
COSMÉTICOS

pag IV



PERSONALIZATION  
PERSONALIZZAZIONI  
PERSONNALISATIONS  
PERSÖNLICHE GESTALTUNG  
PERSONALIZACIONES

pag 218

\*

Available only front or front and back label  
Disponibile etichetta solo fronte o fronte e retro  
Disponible étiquette seulement recto ou recto et verso  
Erhaeltlich nur: Vorderseite oder Vorder- und rueckseite etikett  
Disponibile etiqueta sólo frontal o frontal y trasera



CAPS  
TAPPI  
BOUCHONS  
VERSCHLÜSSE  
TAPONES



● TPFT2\_C-TR

## SSH\_S

Single bracket for dispenser with assembling kit / Staffa singola per dispenser con kit di montaggio / Support single pour dispenser avec kit de montage / Einzelhalterung für Spenderflaschen mit Befestigungs-Kit / Soporte individual en acero inoxidable para botella con kit de montaje

207 x 36 x 54 mm



## FLP

Pump / Pompa / Pompe / Pumpe / Bomba



●FLP\_TR



●FLP\_NE



●FLP\_TA



## SSH\_D

Double bracket for dispenser with assembling kit / Staffa doppia per dispenser con kit di montaggio / Support double pour dispenser avec kit de montage / Doppelhalterung für Spenderflaschen mit Befestigungs-Kit / Soporte doble en acero inoxidable para botella con kit de montaje

210 x 103 x 54 mm

## SSB\_R

Round bottom plate / Fondello tondo / Fond rond / Rund grundelement / Placa de fondo redonda

